

**ASMA TAVAN PROFİLLERİ  
CEILING SYSTEMS PROFILES**

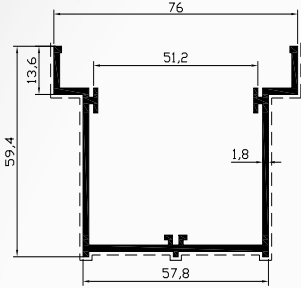

Profil No : 3584  
Gramaj : 1.037 kg/m  
Çevre : 439 mm

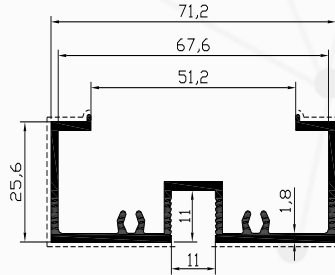

Profil No : 3585  
Gramaj : 0.855 kg/m  
Çevre : 364 mm

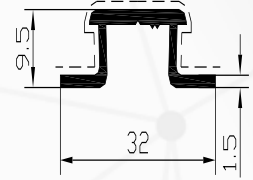

Profil No : 3586  
Gramaj : 0.223 kg/m  
Çevre : 105 mm

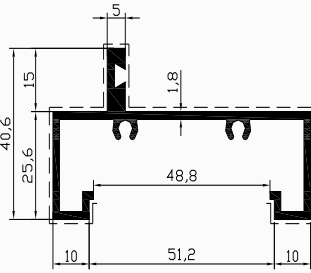

Profil No : 3587  
Gramaj : 0.974 kg/m  
Çevre : 372 mm

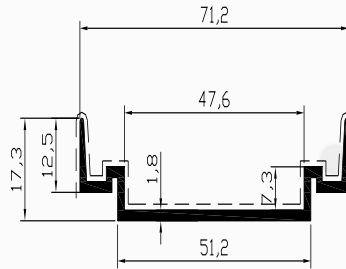

Profil No : 3588  
Gramaj : 0.518 kg/m  
Çevre : 226 mm

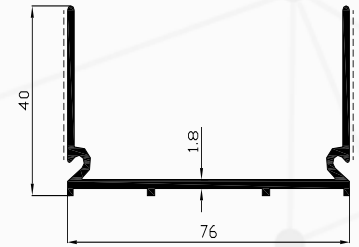

Profil No : 3589  
Gramaj : 0.816 kg/m  
Çevre : 332 mm

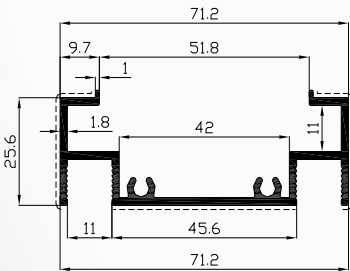

Profil No : 3590  
Gramaj : 0.848 kg/m  
Çevre : 368 mm

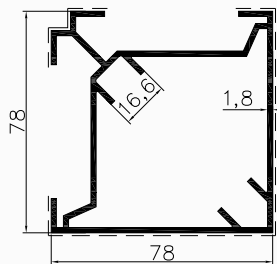

Profil No : 3591  
Gramaj : 1.906 kg/m  
Çevre : 442 mm

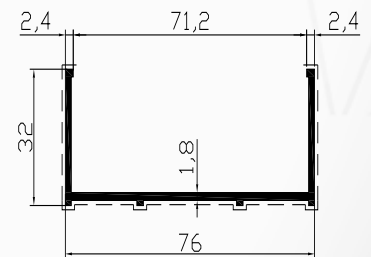

Profil No : 3592  
Gramaj : 0.684 kg/m  
Çevre : 284 mm

## ASMA TAVAN PROFİLLERİ CEILING SYSTEMS PROFILES

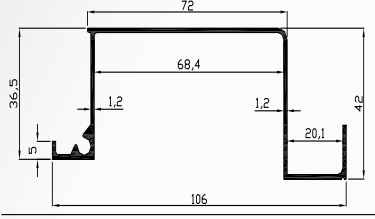

Profil No : 3593  
Gramaj : 0.690 kg/m  
Çevre : 406 mm

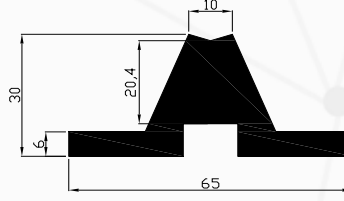

Profil No : 3594  
Gramaj : 2.066 kg/m  
Çevre : 191 mm

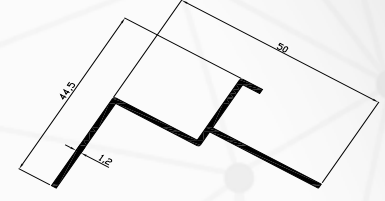

Profil No : 3836  
Gramaj : 0.317 kg/m  
Çevre : 197 mm

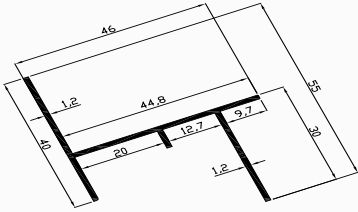

Profil No : 3837  
Gramaj : 0.387 kg/m  
Çevre : 241 mm

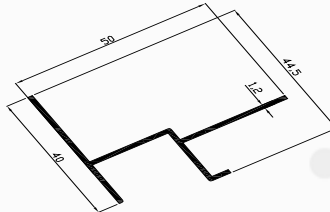

Profil No : 3838  
Gramaj : 0.362 kg/m  
Çevre : 225 mm

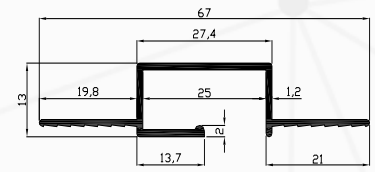

Profil No : 3839  
Gramaj : 0.321 kg/m  
Çevre : 211 mm

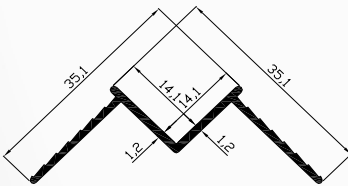

Profil No : 3840  
Gramaj : 0.207 kg/m  
Çevre : 141 mm

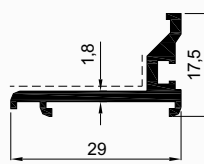

Profil No : 4027  
Gramaj : 0.260 kg/m  
Çevre : 111 mm

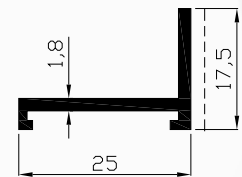

Profil No : 4028  
Gramaj : 0.214 kg/m  
Çevre : 94 mm